



HGPO Meeting February 8, 2012

Harford Trophy Meet

- 1) Sessions/Times (Stefanie)
- 2) Floor Layout (Rick/Laura)
- 3) Concessions (DeAnna/Suzanne)
- 4) Hospitality (Sherrie/Trish)
- 5) Equipment/Loaner Equipment (Winns)
 - Tables/Chairs
 - ForkLift
 - Stanchions
- 6) Vendors (Laura)
- 7) TVs and computer scoring (Pat F/Glen G)
- 8) Admissions/Parent Check in/Gymnast Check in (Michele/Monica)
- 9) Goodie Bag/T-Shirt/Pins(Heather B)
- 10) Parent Volunteers shirts (Colleen)
- 11) Signage/Decorations (Donna/Colleen)
- 12) Awards (Leslie/Candace)
- 13) Timers (Erin)
- 14) Volunteer status (Nancy)
- 15) Setup/Breakdown (Rick)

Any Other Business –Banquet, etc.

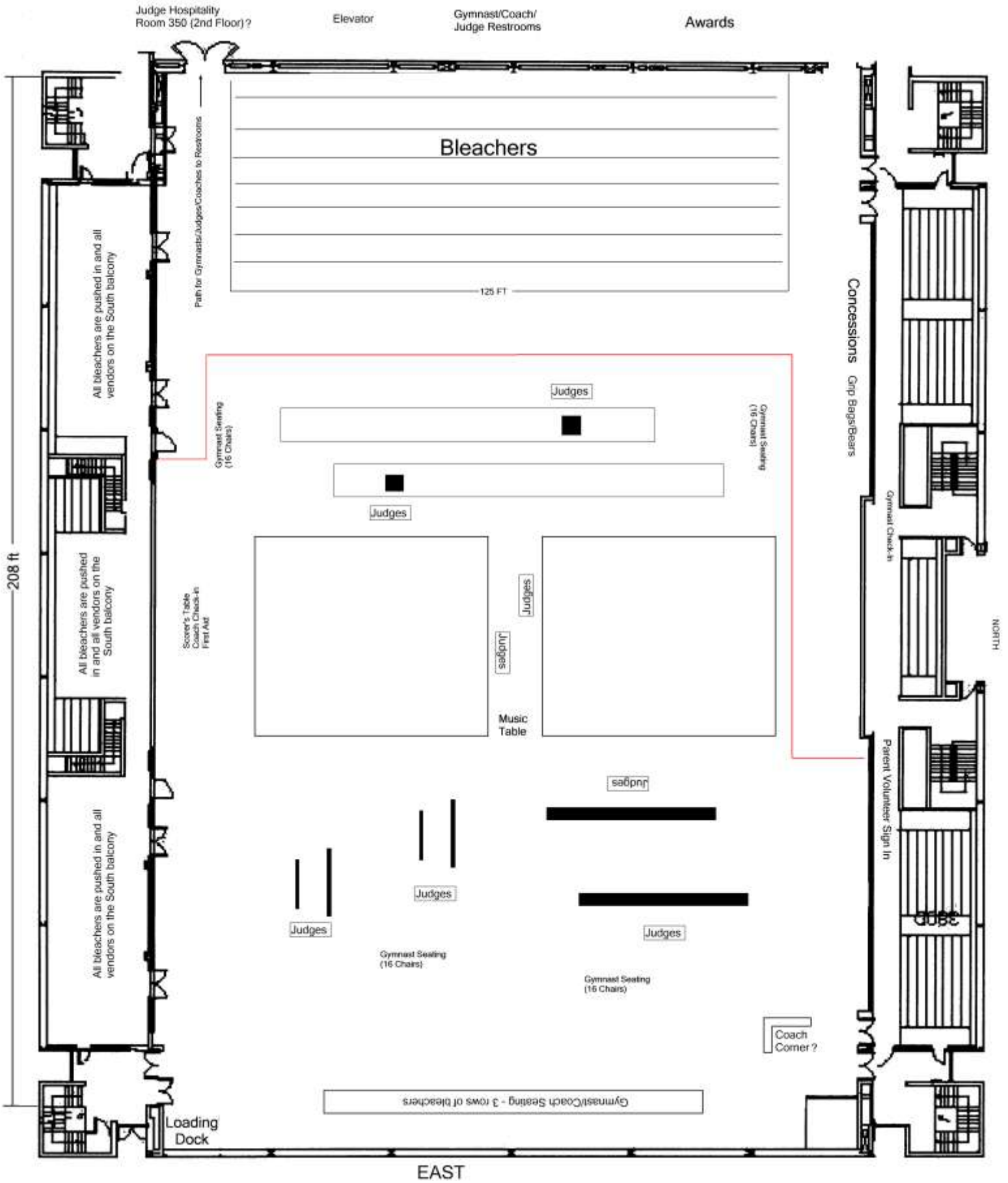

208 ft

Judge Hospitality Room 350 (2nd Floor)?

Elevator

Gymnast/Coach/Judge Restrooms

Awards

Bleachers

125 FT

All bleachers are pushed in and all vendors on the South balcony

Path for Gymnasts/Judges/Coaches to Restrooms

Gymnast Seating (16 Chairs)

Judges

Gymnast Seating (16 Chairs)

Judges

Score's Table
Coach Check-in
First Aid

seating

Judges

Music Table

All bleachers are pushed in and all vendors on the South balcony

Concessions
Grip Bags/Bears

Gymnast Check-in

NORTH

Parent Volunteer Sign In

Judges

seating

Judges

Gymnast Seating (16 Chairs)

Gymnast Seating (16 Chairs)

Judges

Coach Corner?

Loading Dock

Gymnast/Coach Seating - 3 rows of bleachers

EAST